



## 1 bed apartment to buy in L2

7 Tithebarn Street, Liverpool, Merseyside,  
L2 2AA

**£65,000** Starting Bid

 x1  x1  x1

Tenure

**Leasehold**

## Property features

- ✓ Being Sold via Secure Sale online bidding. Terms and Conditions
- ✓ Apartment
- ✓ One Bedroom
- ✓ EPC Rating C

## Key Information

- ✓ Council Tax: Band B
- ✓ EPC Rating: C
- ✓ Heating supply: Electric
- ✓ Electric supply: National Grid
- ✓ Water supply: Direct mains water

## Description

We are delighted to market this wonderful one bedroom apartment in Silkhouse Court. This fully furnished property offers well lit, spacious accommodation in the heart of the business district, just a 5-minute walk from Liverpool One.

The property is located on the fifth floor and comprises an entrance hallway leading through to an open plan living room and contemporary kitchen with integrated appliances, a double bedroom and a beautiful tiled three-piece bathroom.

Council Tax Band: B

Tenure: Leasehold

Length of Lease: 240

Annual Ground Rent Amount: £690.00

Annual Service Charge Amount: £1,877.00

Price: Starting Bid £65,000

Property Type: Apartment

Parking: None

Risk of floods and or erosion: No

Flooded in last 5 years: No

Flood defences: No

Listed property: No

Heating: Electric

Electric: National Grid

Water: Direct mains water

Water meter: Yes

Sewerage: Standard UK domestic

Air conditioning: No

Approx Gross Internal Area  
44 sq m / 471 sq ft

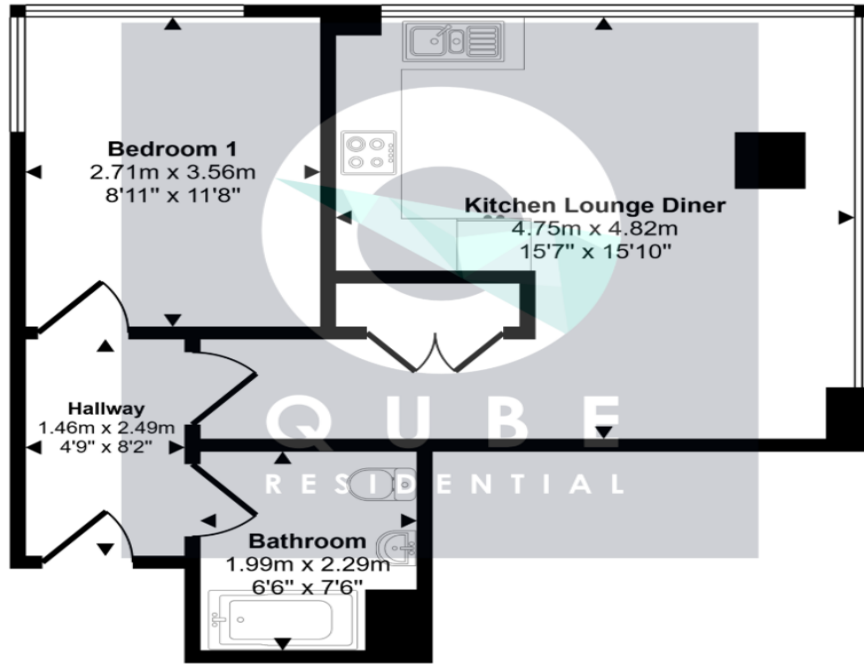

Floorplan

Energy Efficiency Rating		
	Current	Potential
<i>Very energy efficient - lower running costs</i>		
(92-100) <b>A</b>		
(81-91) <b>B</b>		
(69-80) <b>C</b>	75	75
(55-68) <b>D</b>		
(39-54) <b>E</b>		
(21-38) <b>F</b>		
(1-20) <b>G</b>		
<i>Not energy efficient - higher running costs</i>		
<b>England, Scotland &amp; Wales</b>	EU Directive 2002/91/EC	

7 Tithebarn Street, Liverpool, Merseyside, L2 2AA

Contact your local branch today for more information on this property:

**HEAD OFFICE 1 PAVILION SQUARE, WESTHOUGHTON, BOLTON, LANCASHIRE, BL5 3AJ,**

<https://www.simply-residential.co.uk/>

These particulars, whilst believed to be accurate are set out as a general outline only for guidance and do not constitute any part of an offer or contract. Intending purchasers should not rely on them as statements of representation of fact, but must satisfy themselves by inspection or otherwise as to their accuracy. No person in this firm's employment has the authority to make or give any representation or warranty in respect of the property.

